

SL15 1nm Solar Marine Light

This equipment complies with requirements of the U.S. Coast Guard in 33 CFR part 66

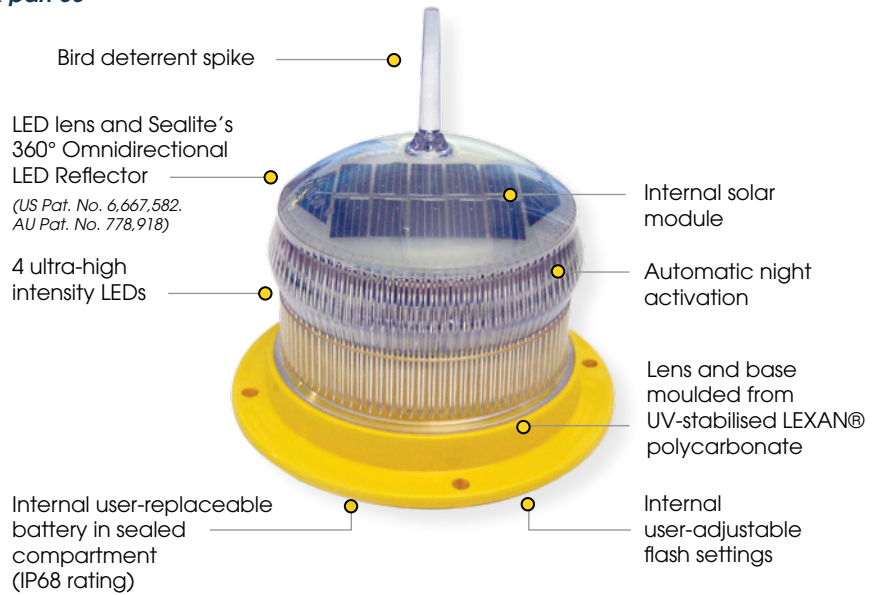

Now available with user-adjustable flash settings



The Sealite Advantage

- User-adjustable flash characters
- User-replaceable battery in sealed battery compartment
- NiMH battery for long service life & wide temperature range
- Completely sealed & self-contained using ultrasonic welding techniques
- Installs in minutes & operates maintenance-free for up to five years
- IP68 waterproof

The Sealite SL15 1nm compact LED light is exceptional value and incorporates some of the most advanced technology available. In the tradition of Sealite lanterns, the SL15 is designed to be maintenance-free and have a service life of over 5 years.

The SL15 can be installed in minutes, and requires no operator intervention. The flash characters are user-adjustable, and the unit is supplied ready for immediate installation.

During daylight hours the solar module will charge the battery, and the lantern will automatically begin operation at dusk – once the ambient light threshold drops sufficiently.

The SL15 features the Sealite LED 360° Omnidirectional Reflector, which increases the intensity and uniformity of the horizontal output. The tough polycarbonate lens is specifically designed for use with LEDs, and incorporates an environment-friendly spike – deterring unwelcome bird life.

The unit is sealed using an advanced ultrasonic weld, enabling a rugged and completely waterproof seal capable of prolonged and deep immersion (IP68).

Optional ON/OFF Switch (SL15-SW)

The SL15 is also available with an optional ON/OFF switch for temporary installations such as worksites.



SL15 solar light on FAD, Australia



SL15 marina lights, Vigo, Spain



Head Office:
Sealite Pty Ltd
AUSTRALIA

Ph. +61 (0)3 5977 6128
Fax. +61 (0)3 5977 6124
Internet: www.sealite.com.au
Email: info@sealite.com.au

USA Customers:
Sealite USA
USA (Gilford, NH)

Ph. (603) 524-6066
Fax. (603) 524-8100
Internet: www.sealiteusa.com
Email: info@sealiteusa.com

SL15 1nm Solar Marine Light



User replaceable battery



SL15 with optional ON/OFF switch (SL15-SW)

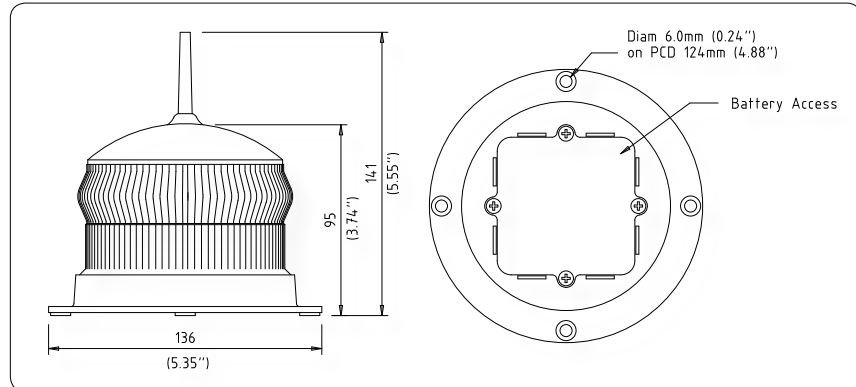

SPECIFICATIONS •

Light Characteristics

Light Source 4 ultra-high intensity LEDs
 Available Colours Red, Green, White, Yellow, Blue
 Peak Intensity (cd) Red - 2.2 Green - 2.4 White - 4.1 Yellow - 1.0
 Visible Range (nm) >1
 Horizontal Output (degrees) 360
 Vertical Divergence (degrees) 9
 Reflector Type Omnidirectional 360° LED Reflector (US Pat. No. 6,667,582. AU Pat. No. 778,918)

Available Flash Characteristics

Intensity Adjustments 16 user-adjustable IALA flash characteristics (other flash patterns available on request)
 LED Life Expectancy (hours) 100% as standard (custom intensity available on request) >100,000

Electrical Characteristics

Current Draw (mA) Minimal
 Circuit Protection Integrated
 Nominal Voltage (v) 3.6
 Autonomy (days) >20 (14 hour darkness, 12.5% duty cycle)
 Temperature Range -40 to 80°C

Solar Characteristics

Solar Module Type Multicrystalline
 Output (watts) 0.45
 Solar Module Efficiency (%) 14
 Charging Regulation Microprocessor controlled

Power Supply

Battery Type High grade NIMH - Environment friendly
 Battery Capacity (Ah) 1.6
 Nominal Voltage (v) 3.6
 Battery Service Life Average 5 years

Physical Characteristics

Body Material LEXAN® Polycarbonate - UV-stabilised
 Lens Material LEXAN® Polycarbonate - UV-stabilised
 Lens Diameter (mm/inches) 107 / 4 1/4
 Lens Design External optics with interior flute design
 Mounting 4 x 6mm mounting holes
 Height (mm/inches) 141 / 5 1/2
 Width (mm/inches) 136 / 5 3/8
 Mass (kg/lbs) 0.6 / 1 1/8
 Product Life Expectancy Up to 12 years

Certifications

CE EN61000-6-3:1997. EN61000-6-1:1997
 Quality Assurance ISO9001:2000
 Waterproof IP68

Intellectual Property

Patents US Pat. No. 6,667,582. AU Pat. No. 778,918
 Trademarks SEALITE® is a registered trademark of Sealite Pty Ltd

Warranty *

Full 3 years

Options Available

- ON/OFF switch (SL15-SW)
- Custom flash patterns
- 50mm pole mount adaptor plate

CE

USER-ADJUSTABLE FLASH PATTERNS

FLASH SETTING CODE	Flash Sequence (on, off, on...)
0	STEADY LIGHT (intensity reduced)
1	0.5, 1.0
2	0.5, 3.5
3	1.0, 3.0
4	0.5, 5.5
5	0.3, 0.7
6	0.3, 0.7, 0.3, 0.7, 0.3, 0.7, 0.3, 15.7
7	0.3, 1.7
8	0.3, 2.2
9	0.5, 2.0
A	0.3, 2.7
B	0.5, 2.5
C	0.7, 2.3
D	0.5, 4.5
E	Custom Setting

Other flash patterns are available on request

• Specifications subject to change or variation without notice

* Subject to standard terms and conditions



Head Office:
Sealite Pty Ltd
AUSTRALIA

Ph. +61 (0)3 5977 6128
 Fax. +61 (0)3 5977 6124
 Internet: www.sealite.com.au
 Email: info@sealite.com.au

USA Customers:
Sealite USA
USA (Gilford, NH)

Ph. (603) 524-6066
 Fax. (603) 524-8100
 Internet: www.sealiteusa.com
 Email: info@sealiteusa.com